



# **CDE5 Specifications**

## Contents

1、 About the User Manual.....	2
2、 Characteristics.....	2
3、 Functions.....	2

## 1、 About the User Manual

Dear users,

to ensure better performance of your e-bike, please read carefully through the CDE5 Specifications before using it.

## 2、 Characteristics

Dimension in Figure 1: (unit: mm)

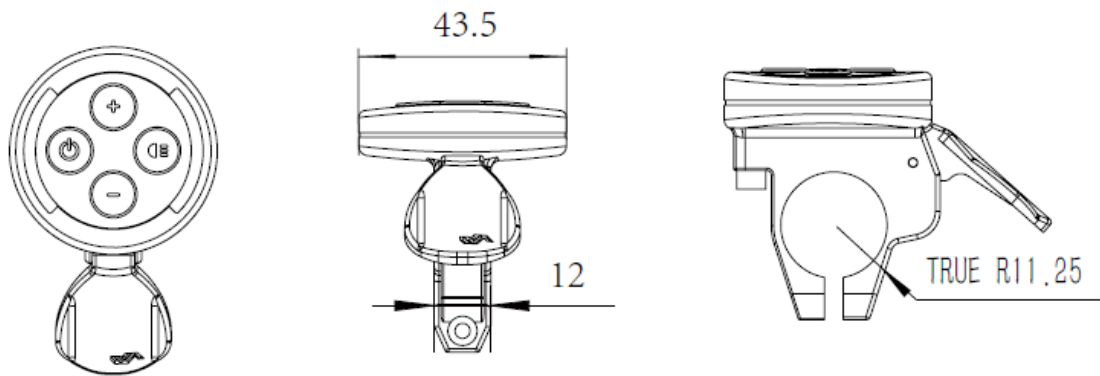
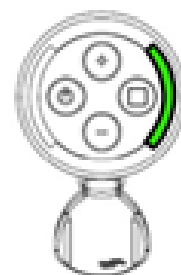



Figure 1

## 3、 Functions

- While the display is off, press and hold the power button for 2 seconds to turn on the power.
- Press the power button for 5 seconds to turn off the power.
- With the display on, press the “+” to increase or “-” to decrease the assistance level, visible on the right side. There are 5 assistance levels:

- No LED: level 0 (no assistance)
- One flashing green LED: level 1
- One steady green LED: level 2
- One steady and one flashing green LEDs: level 3
- Two steady green LEDs: level 4
- Three steady green LEDs: level 5



d. While the display is on, hold  to activate Walking Assisted Mode. This mode will help you push the ebike by foot up to a maximum of 6 km/h speed (while in 0 assistance level, it can be activated also with the throttle)





e. The residual charge of the battery is visible on the left side of the display:

- Three steady **green** LEDs: 100%
- Two steady **green** LEDs: 50%
- One steady **green** LED: 25%
- Flashing **red** LED: 10%

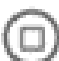

f. With screen on and two flashing red LEDs, please contact immediately the Technical Support to report malfunctions.

### Buttons:

-  Power Button
-  Increase Assistance Level
-  Decrease Assistance Level
-  Walking Assisted Mode (if held)
-  Throttle (only in 0 Assistance Level)